

FUMECUBE PRO

Compact, multi-use fume extraction unit
Single and dual arm variants

PUREX
CLEAN AIR FOR EVERYONE



Description & features

- VariColour filter blocked warning system
- Highest grade HEPA and carbon technology
- Automatic electronic flow control - maintains a constant extraction rate even as the filter blocks
- Quiet in operation
- Simple to install and easy to relocate

Filters



Main Filter Code

113831

Description

HEPA/Chemical

Single

Dual



OR



Pre-Filter Code

111197 (Single)

Description

F8/F9 Labyrinth

111195 (Dual)

Specification

Voltage	120v	230v
Single Arm Part Number	072175	072650
Dual Arm Part Number	072171	072600
Wattage	0.32kW	
Frequency	50Hz / 60Hz	
Cabinet Height	680mm	
Cabinet Width	350mm	
Cabinet Depth	335mm	
Cabinet Weight	25kG	
Airflow	170m3/h	
Sound Level	<60dBa	

Machine supplied with

• 1 x Main Filter • 1 x Pre-filter • 1 or 2 x Connection Kit • 1 x Power Cable • 1 x Manual

Find out more: W purex.co.uk | [T +44 \(0\)1405 746030](tel:+44(0)1405746030) | [E purex@purex.co.uk](mailto:purex@purex.co.uk)

Registered Office: Purex International LTD, Unit A, Saltgrounds Road, Brough, HU15 1EG, UK

Registered No. 5136616 England | VAT No. GB842 5025 49 | WEEE Producer Registration Number: WEE/CE0067TX

*Goods are subject to change | *Illustrations are 3D created visual representations

FUMECUBE PRO

Compact, multi-use fume extraction unit
Single and dual arm variants

Options

Connection kits

If you do not see a connection kit that fits your machine or pipework, please contact Purex or your representative

Pen Nib + Clamped Bracket

Code	Length
100295L	38mm

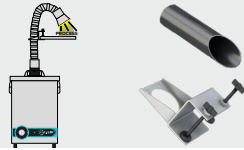

Clear Hood Cowl + Clamped Bracket

Code	Length
100299	50mm

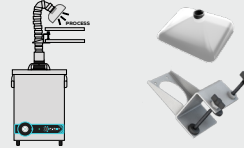

Flexihose + 2 Connecting Cuffs

Code	Length
120117	50mm



Conical Cowl + Screw Bracket

Code	Length
100293	38mm

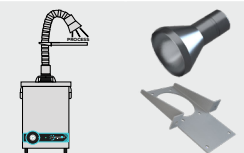

Pen Nib + Screw Bracket

Code	Length
100294	38mm

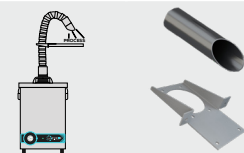

Conical Cowl + Pen Nib + Clamped Bracket

Code	Length
100295ESD	38mm

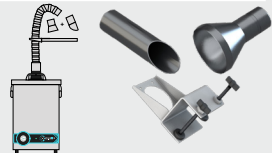

Interfacing

Interfacing can remotely start the Purex machine when the connected machine starts.

Interfacing can also warn the connected machine when the Purex machine is in alarm.

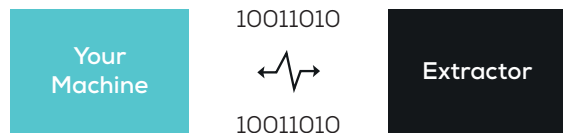

Take a look through our [Interfacing Guide](#) to see our extensive range of options