

# FUMECUBE PRO

Compact, multi-use fume extraction unit  
Single and dual arm variants

**PUREX**  
CLEAN AIR FOR EVERYONE



## Description & features

- VariColour filter blocked warning system
- Highest grade HEPA and carbon technology
- Automatic electronic flow control - maintains a constant extraction rate even as the filter blocks
- Quiet in operation
- Simple to install and easy to relocate

## Filters



Main Filter Code

113831

Description

HEPA/Chemical

Single

Dual



OR



Pre-Filter Code

111197 (Single)

111195 (Dual)

Description

F8/F9 Labyrinth

## Specification

Voltage	120v	230v
Single Arm Part Number	072175	072650
Dual Arm Part Number	072171	072600
Wattage	0.32kW	
Frequency	50Hz / 60Hz	
Cabinet Height	680mm	
Cabinet Width	350mm	
Cabinet Depth	335mm	
Cabinet Weight	25kG	
Airflow	170m3/h	
Sound Level	<60dBa	

## Machine supplied with

• 1 x Main Filter • 1 x Pre-filter • 1 or 2 x Connection Kit • 1 x Power Cable • 1 x Manual

Find out more: [Wpurex.co.uk](http://Wpurex.co.uk) | [T +44 \(0\)1405 746030](tel:+44(0)1405746030) | [E purex@purex.co.uk](mailto:purex@purex.co.uk)

Registered Office: Purex International Limited, QWP House, Island Drive, Capitol Park, Thorne, Doncaster DN8 5UE  
Registered No. 5136616 England | VAT No. GB842 5025 49 | WEEE Producer Registration Number: WEE/CE0067TX  
\*Goods are subject to change | \*Illustrations are 3D created visual representations

# FUMECUBE PRO

Compact, multi-use fume extraction unit  
Single and dual arm variants

# Options

## Connection kits

If you do not see a connection kit that fits your machine or pipework, please contact Purex or your representative

### Pen Nib + Clamped Bracket

Code	Length
100295L	38mm

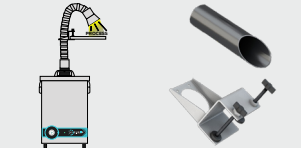

### Clear Hood Cowl + Clamped Bracket

Code	Length
100299	50mm

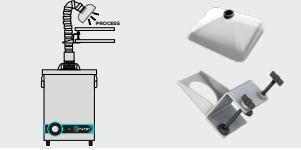

### Flexihose + 2 Connecting Cuffs

Code	Length
120117	50mm



### Conical Cowl + Screw Bracket

Code	Length
100293	38mm

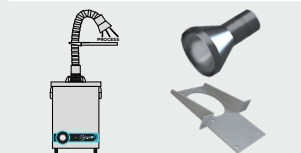

### Pen Nib + Screw Bracket

Code	Length
100294	38mm

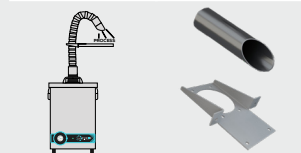

### Conical Cowl + Pen Nib + Clamped Bracket

Code	Length
100295ESD	38mm



## Interfacing

Interfacing can remotely start the Purex machine when the connected machine starts.

Interfacing can also warn the connected machine when the Purex machine is in alarm.

Your Machine

10011010



Extractor

10011010

Take a look through our [Interfacing Guide](#) to see our extensive range of options